

**BCK Holland B.V.**

Spuiweg 24  
5145 NE Waalwijk  
The Netherlands

[T] +31(0)416 673 880  
[F] +31(0)416 673 888  
sales@bckholland.com  
www.bckholland.com

KvK : 18076783  
VAT nr : NL813897075B01  
Bank nr : ING 67.65.07.611  
BIC : INGBNL2A  
IBAN : NL32INGB0676507611

# BCK VEHO Configurator 360 Manual

Version 1

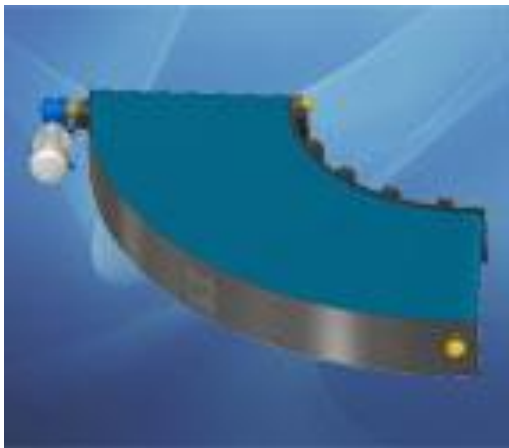

## Index

1. General.....	2
2. Accessibility Configurator .....	2
3. VEHO Round conveyor Configurator .....	2
4. Configuration of the 3D model .....	3
5. Standard options VEHO configurator. ....	3

## 1. General

The BCK Configurator 360 aims to quickly configure 3D models and download them for use in custom 3D designs. The 3D models can be downloaded as STEP or SAT file.

It is also possible to request an advice or quotation of the configured model.

Standards were assumed when designing the configurator. There are many more options outside the standards. If you want a different belt color, the motor or legs of the support in a different location, shorter side guides, etc., please contact the sales department.

No rights can be derived from the configured models. Upon a quotation request, your configured model will be assessed by BCK Holland B.V.

## 2. Accessibility Configurator

The configurator is accessible from the BCK website where no registration or login is required. The direct link to the VEHO configurator is: <https://www.bckholland.com/nl/configurator-veho-curve> .

## 3. VEHO Round conveyor Configurator

After you have clicked on the link you will be redirected to the BCK Holland website.

If you do not see the configurator immediately, press F5 to refresh the page. The first loading time takes on average 10 to 20 seconds. On the left you will find the input screen by which you can configure the belt conveyor.

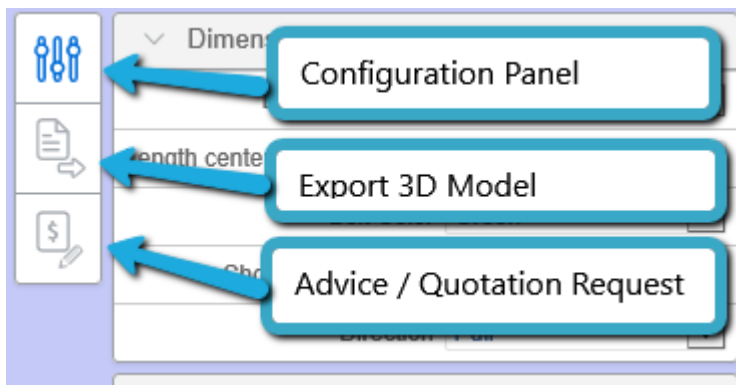

1. **Configuration panel**, Control panel, this is open by default. If you have exported a 3D model or have made an Advice / Quotation request, you can call up the configuration screen again via this button.
2. **Export 3D Model**, This allows you to export your configured model to a STEP or SAT file.
3. **Advice / Quotation Request**, if you want advice whether your configured model meets the requirements and / or you want a quote, you can do that via this button. The configured model is then saved so that BCK Holland B.V. can assess it.

#### 4. Configuration of the 3D model

The fully expanded configuration screen looks like this:

Inside radius (mm)	600
Beltwidth (mm)	600
Angle (deg)	90
Direction	CW
Drive position	Outside

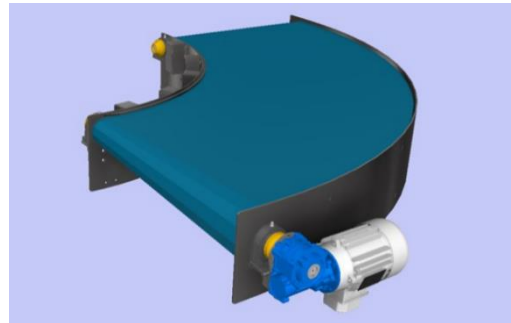

By making a choice from the drop-down menus, the 3D model will be adjusted immediately. This takes around 1 to 10 seconds.

#### 5. Standard options VEHO configurator.

The plastic modular belt for the VEHO Curve round bend is produced with a fixed inner radius of 600 mm.

Chain Width (mm)	Inside radius (mm)	Outside radius (mm)	Transfer nose (mm)
200	600	800	Ø70-Ø90
400	600	1.000	Ø70-Ø110
600	600	1.200	Ø70-Ø130
800	600	1.400	Ø70-Ø150
1.000	600	1.600	Ø70-Ø170
1.200	600	1.800	Ø70-Ø190
1.400	600	2.000	Ø70-Ø210
1.600	600	2.200	Ø70-Ø230
1.800	600	2.400	Ø70-Ø250

Note: the dimensions marked in orange are not yet available in the configurator. If you need a 3D model of these dimensions, please contact us.

#### Angle

The VEHO Curve is available in an angle (center to center) from 15° to 350°.

In the configurator you can choose from the following angles:

30 – 45 - 60 – 90 – 180 degrees.

If you need a different angle, please contact us.

#### Additional information VEHO Curve

Information about the VEHO Curve can be found on the website of our sister company Kramer & Duyvis B.V.: <https://www.kramer-duyvis.com/nl/products/circular-transporter-type-veho-curve>